

PRODUCT DETAILS

THREEPHASE ELECTRIC MOTOR 9,2kW

T41339/2NR1G5KG

DIMENSIONS

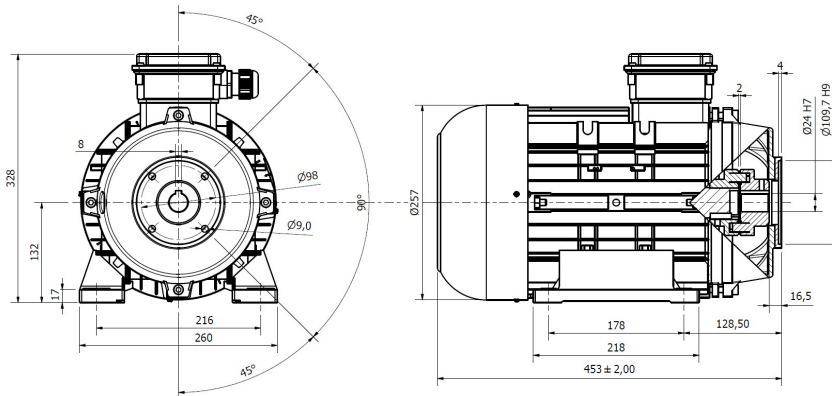

Insulation	: cl. F
Protection IP	: 55
Frame IEC	: 132M
Service	: S1
Color	: RAL9005
Material	: Alluminium
Coupling	: KTR AR38 24/38
Thermik	: 2xS01 150°C

DATA

Type	RN 132Mb4
Rated Power	9,2 kW
RPM	1440 g/m
Electrical supply	400/690V-50Hz
Efficiency	81,5 %
Power factor	cosφ 0,85
Current	(400V) 19,2 Amp
D.O.L. Current start.	(IS/IN) 7,5
Torque	61,0 Nm
Starting Torque	(Cs/Cn) 2,8
Max Torque	(Cm/Cn) 2,8
Moment of inertia	0,033
Weight	55,0 Kgs

Three - phase connection
Star connection

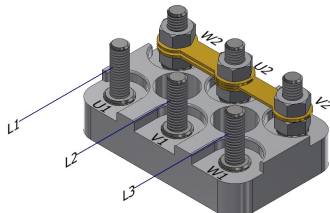

Three - phase connection
Triangle connection

