



P.A. - S.r.l. - EQUIPAGGIAMENTI TECNICI DEL LAVAGGIO

VIA MILANO, 13 - 42048 RUBIERA (REGGIO EMILIA) - ITALY - Tel. +39 0522 623611 (10 linee)
 Fax +39 0522 629600 - R.E.A. RE 156319 - Registro Imprese RE 11535 - Mecc. RE 013446
 C.F. e P.IVA 01035950359 - Cap. Soc. i.v. € 750.000,00 - Codice Identificativo C.E.E. IT 01035950359
 ART. 2497 - BIS C.C. DIREZIONE E COORDINAMENTO BENETTI srl R.I. TRIB. DI RE 01480690351
<http://www.pa-etl.it> - E-mail: info@pa-etl.it



DA - Descaling injector electro powered

Technical manual: **E 807**

The electric motor drives a cam, which operates on a flexible hose, sending the descaling fluid through the circuit.



- **12.5010.00** DA 24 24 Volt
- **12.5011.00** DA 240 230 Volt
- **12.5018.60** DA 115 115 Volt

- Injector compatible with the larger spectrum of descaling fluids.
- The machine is protected by a shock resistant plastic casing.
- Small overall dimensions, lateral and axial.
- Operated by electric motor and gear reduction.

Technical Specifications

Environment Temperature 35 °C

| PART NUMBER | MAX PRESSURE bar - MPa | ABSORBED POWER W | RATED VOLTAGE V | FREQUENCY Hz | MAX FLOW RATE g/h | MAX TEMP. FLUID °C | WEIGHT g |
|-------------------|---------------------------|---------------------|--------------------|-----------------|----------------------|-----------------------|-------------|
| 12.5010.00 | 0.5 – 0.05 | 25 | 24 | 50 | 24 | 40 | 290 |
| 12.5011.00 | 0.5 – 0.05 | 25 | 230 | 50 | 24 | 40 | 290 |
| 12.5018.60 | 0.5 – 0.05 | 25 | 115 | 60 | 24 | 40 | 290 |

Cable length: 1100 mm - wire 2x0.75 mm

Instruction manual, maintenance, installation, spare parts.
 For a correct utilization, follow the directions of this manual.
Re-print them on the use and maintenance booklet of the machine

n. 12.9807.00

DIMENSIONAL DRAWING

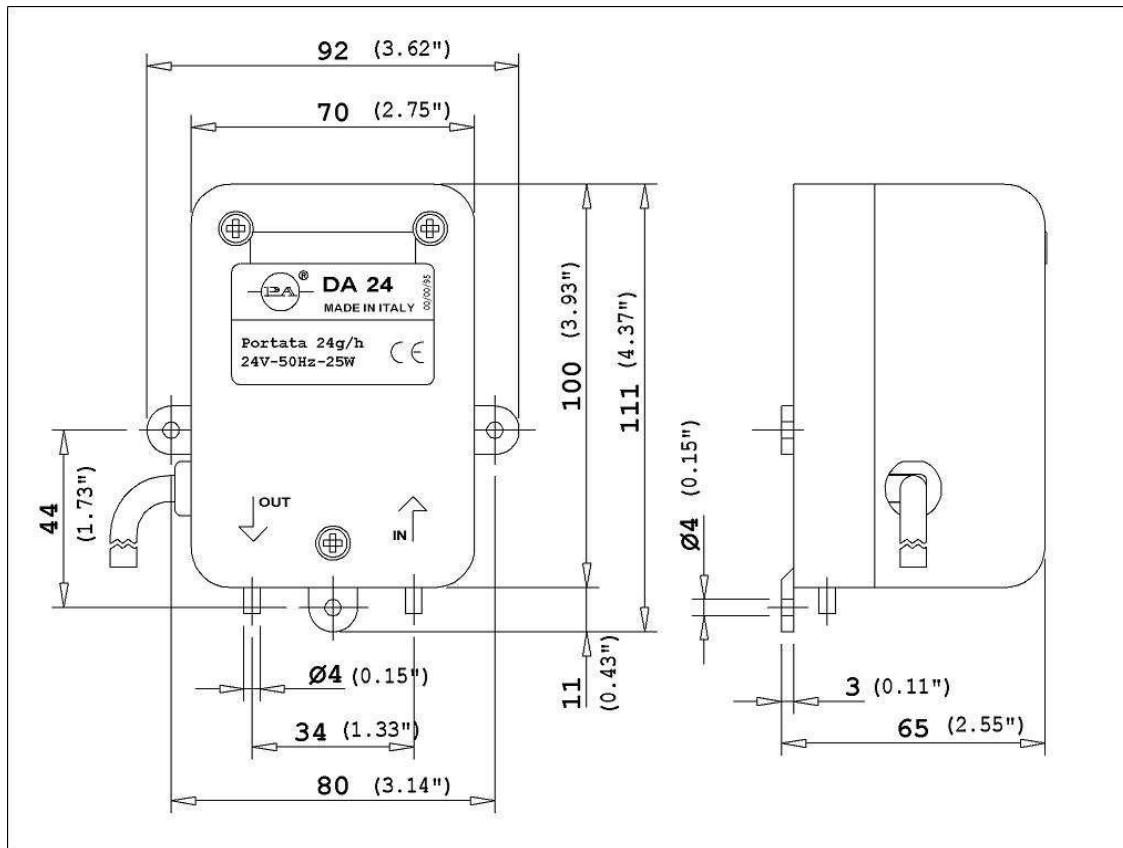

INSTRUCTIONS

SELECTION

These products are suitable for the utilization of descaling fluids, preferably the basic type.

The use of different or corrosive fluids may damage the internal piping. If in doubt, contact the PA Technical dept. Choose the injector in relation to the rated working data (max pressure, max flow, max temperature, max voltage). Keep within the indicated limits of the electrical characteristics as they should always be kept within the max indicated values.

INSTALLATION

Connection to Hydraulic system

Use piping connections in line with the dimensions and performances of the injector. Make sure that their chemical resistance is compatible with the utilized fluid. Avoid restrictions of all passages which may cause malfunctions, pressure reduction and lifespan reductions. This injector cannot be utilized for fluids under pressure, therefore, **take care to connection with sealed containers.**

In order to eliminate polluting elements, if present in the detergent, it is advisable to install a strainer on the suction tube.

Install the injector inside the machine only.

The protection against direct contacts depends on installation.

Connection to Electric system

Before making the electric connection, make sure that the tension of the power supply corresponds to the indicated value in the Technical specifications. Pay attention to the situations of overload and overvoltage which could arise at starting. To avoid these distortions it may be necessary to foresee appropriate protections to the electric system.

The electrical installation should be made by **qualified personnel**

OPERATIONS

To avoid anomalies and defects in operation, install the injector far from heat sources.

PROBLEMS AND SOLUTIONS

| PROBLEMS | PROBABLE CAUSES | SOLUTIONS |
|--------------------------|--|--|
| No detergent outflow | -Insufficient pump intake ducts. -Wrong intake -Pump hose jammed or squashed -Pump hose deteriorated and un-flexible -Electric connection incorrect or disconnected. | -Check the pump intake circuit -Enable air entrance into the tank -Check, clean and/or replace -Replace and check compatibility of descaling liquid. -Check and/or repair. |
| Electric motor overheats | -Contact cams warped -Reduction gear jammed | -Replace -Replace |

REGULATIONS : **see norm manual**

The accessory hereby described bears the CE marking in accordance with the Norms and Directives applied on the **Declaration of Conformity**.

For a correct utilization, follow the directions described in this manual and re-print them on the Use and maintenance manual of the machine

Make sure that you are given the Original Conformity Declaration for the accessory chosen. The present manual is valid for all Pressure switches named **DA**

MAINTENANCE

Maintenance has to be carried out by **Specialized Technicians**

STANDARD: every 400 working hours (circa 10,000 cycles), check and lubricate the seals with water resistant grease.

SPECIAL: every 800 working hours(circa 20,000 cycles), control the wear of the seals and internal parts and if necessary, replace with original PA parts taking care during installation and to lubricate with water resistant grease.

For a correct assembly, follow the phases indicated on the exploded view referred.

The manufacturer is not to be considered responsible for damage as a result from incorrect fitting and maintenance

Technical data, descriptions and illustrations are indicative and liable to modification without notice

12.5010.00 DA24-Descaling Pump 24V

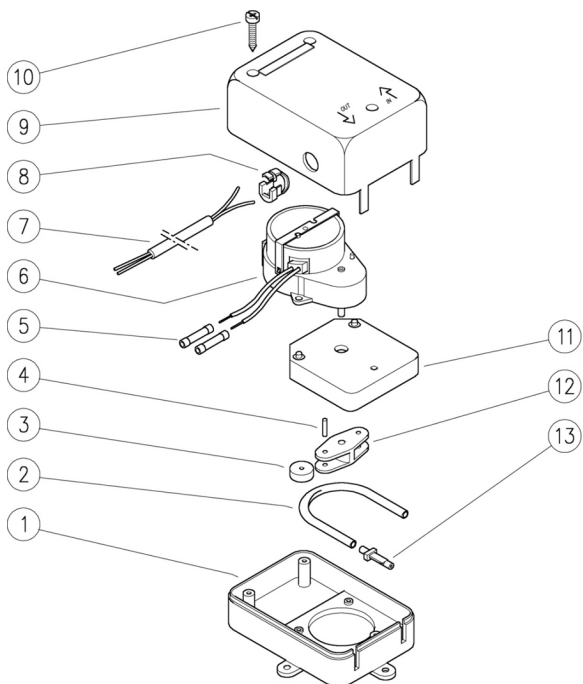

12.5011.00 DA240-Descaling pump 230V

| Pos. | P/N | Description | Q.ty | K1 | K2 | K3 | K4 |  |
|------|------------|------------------------------------|------|----|----|----|----|---|
| 1 | 21.2003.84 | Lower Protection | 1 | | | | | 1 |
| 2 | 21.2006.85 | Hose | 1 | | | | | 5 |
| 3 | 21.2008.84 | Wheel | 2 | | | | | 5 |
| 4 | 15.1015.12 | Parallel pin, 2,5x12 mm Sst. | 2 | | | | | 10 |
| 5 | 12.5017.00 | Terminal | 2 | | | | | 10 |
| 6 | 13.0821.24 | Gearmotor, 24V AC (1) | 1 | | | | | 1 |
| 6 | 13.0822.00 | Gearmotor, 230V AC (2) | 1 | | | | | 1 |
| 7 | 21.2007.21 | Cable, 2x0,75 L.1100 mm | 1 | | | | | 1 |
| 8 | 21.2001.84 | Cable gland | 1 | | | | | 5 |
| 9 | 21.2004.84 | Upper protection | 1 | | | | | 1 |
| 10 | 16.3077.00 | S/tapping screw, DIN7981 3,5x18 mm | 3 | | | | | 10 |
| 11 | 21.2002.84 | Motor bracket | 1 | | | | | 3 |
| 12 | 21.2009.84 | Wheel bracket | 1 | | | | | 3 |
| 13 | 21.2005.84 | Hose barb | 2 | | | | | 5 |

(1) 12.5010.00 (2) 12.5011.00